

PACIFIC LUTHERAN UNIVERSITY

Class Schedule

SPRING - 1971



Tacoma, Washington 98447

SCHOOL CALENDAR

INTERIM AND SPRING ADVANCE REGISTRATION BEGINS NOVEMBER 2ND

INTERIM

Begins.....Monday, January 4
Ends.....Friday, January 29

SPRING

Registration.....Wednesday, February 3
Classes begin 7:50 a.m.....Thursday, February 4
Last date for adding a course.....Thursday, February 18
Washington's Birthday Holiday.....Monday, February 22
Late date for discontinuing a course
without receiving a grade.....Thursday, February 25
Date for giving deficiency grades.....Friday, March 12
Mid-semester break begins 10:00 p.m.....Tuesday, April 6
Mid-semester break ends 7:50 a.m.....Wednesday, April 14
Examinations.....Tuesday, May 18--Friday, May 21
Semester ends.....Friday, May 21
Baccalaureate Service, 11:00 a.m.....Sunday, May 23
Commencement, 3:30 p.m.....Sunday, May 23

The 1970 Class Schedule offerings are listed alphabetically, according to departments and schools. Courses open to freshmen and sophomores are numbered 101-299 and are considered lower division subjects. With the exception of the Interim, courses open to juniors and seniors are numbered 300-499 and are regarded as upper division subjects. Courses numbered 500 are open to graduate students only.

Upon the approval of his adviser and with the consent of the instructor, a lower division student may be assigned to an upper division course if the pre-requisites for the course have been met.

The University reserves the right to cancel any class for justifiable cause.

BUILDING SYMBOLS

A....Administration	I....Ivy Hall
AB...Art Building	L....Library
E....Eastvold Chapel	R....Ramstad Hall(Science Building)
G....Memorial Gymnasium	X....Xavier Hall
O....Olson Auditorium	

DAY CODES

M - Monday
T - Tuesday
W - Wednesday
R - Thursday
F - Friday
S - Saturday

PERIODS

Unless otherwise noted, the time indicated for each class is the beginning of a 50 minute period.

GENERAL REGISTRATION DIRECTIONS

PLEASE INDICATE THE SYSTEM CODE NUMBER FOR EACH COURSE REGISTRATION.

1. All students currently in school who plan to register for the following semester (summer excepted) should register by Advance Registration. Note: Interim and Spring registrations are combined and conducted simultaneously.
2. Full-time new and re-entry students may advance register if a clearance has been received from admissions. **Part-time students are encouraged to advance register.**

3. SELECTIVE SERVICE—ATTENTION ALL MALE STUDENTS

If you want your local draft board notified of your full-time enrollment (2½ courses) at P.L.U., it is your responsibility to complete a form in the Registrar's Office. *This is normally done only once a year.*

4. V.A. BENEFITS

If you expect to receive any type of veteran or war orphan benefits, you must file your certificate of eligibility in the Registrar's Office. Forms and information concerning veteran benefits are available in the Registrar's Office. Make application when registering. A student must be registered for 3 courses to be eligible for full-time V.A. Benefits.

5. Obtain your registration materials at the Registrar's Office.
6. Obtain an appointment with your adviser. **DO THIS IMMEDIATELY.**
7. Print with a **BLACK LEAD PENCIL** on your official program.
 - A. Fill in all personal information including your Social Security Number. If you do not have a Social Security Number, you must secure one prior to registering.
 - B. Indicate *SYSTEM CODE NUMBER* for each course registration.
 - C. Print an "A" before audit courses, "R" before repeat courses.
 - D. Check to be certain that you have the pre-requisites, as indicated in the University Catalog, for each course you select.
 - E. *LIST ALTERNATE COURSES* which can be substituted if courses on your original schedule are closed. The listing of alternate courses may prevent a change of registration later.
 - F. Obtain the signature of your adviser if you are a full-time (2½ courses) student.

ADVANCE REGISTRATION ONLY

- A. Leave your registration materials in the Registrar's Office.
- B. Advance registration will be processed by class in the order they are received with seniors first, then juniors, sophomores, and freshmen. Every effort is made to comply with your requests. If a course is closed, an approved alternate will be substituted. Note: Seniors will receive priority in interim courses for the first week of registration only.
- C. You will be mailed a statement of charges including the fee payment deadline, a copy of your scheduled classes, additional instructions, and cards.
- D. Return your payment and the other information requested to the P.L.U. Business Office by the due date indicated.

IN PERSON REGISTRATION

- A. Obtain the necessary cards at the Registrar's Office.
- B. Complete all cards. Obtain adviser's approval if full-time (see "F" above).
- C. Report to the Registrar's Office to be scheduled.
- D. As soon as you are scheduled and receive a copy of your program, report to the Business Office to pay your fees.

INDEPENDENT STUDY REGISTRATION

A special independent study registration card must be submitted to the Registrar's Office with each independent study registration. These cards may be obtained at the Registrar's Office.

PASS--FAIL OPTION for UNDERGRADUATE STUDENTS

A Pass--Fail Agreement form is available to all undergraduate students desiring a course on the pass--fail option. Secure the form from the Registrar's Office.

CHANGE OF REGISTRATION, WITHDRAWALS

Any addition or withdrawal from a course must be made in the Registrar's Office. Changes in registration due to conflicts or errors in registration may be made without charge during the first week of the semester. To withdraw from a class and/or add a class, the following procedure is to be followed:

1. Obtain the change of registration form from the Registrar's Office.
2. Obtain the necessary signature and, if applicable, a withdrawal grade.
3. If after the first week, pay the \$5.00 change of registration fee at the Business Office.
4. Return the change of registration form to the Registrar.

The student is responsible for completing the above steps within one week after obtaining the change card.

Students withdrawing officially from a class after the fourth week of a semester will receive either a WP (withdrawal with passing), a WF (withdrawal with failure), or a WM (Medical Withdrawal). None of these grades will be used in calculating grade point average, but they will appear on the semester grade point report and be included in review of academic status. The grade of W will replace WP, WF, and WM on the transcript.

PERIODS

Unless otherwise noted, the time indicated for each class is the beginning of a 50 minute period.

MAJOR CODES

COLLEGE OF ARTS AND SCIENCES

000 Undecided
002 Art
005 Biology
011 Chemistry
014 Classical Languages
015 Communication Arts
016 Earth Sciences
017 Economics
023 English
026 French
038 German
047 History
056 Mathematics
059 Music
068 Philosophy
070 Physical Education
071 Physics
074 Political Science
077 Psychology
080 Religion
086 Sociology
089 Spanish

Career Programs

In the case of a career program, change the first digit to the letter designated beside the career, then add the last two digits of the major
EXAMPLE: A Pre-Medicine student with a major in biology is coded D05. A Pre-Law student with a major in Political Science is coded C74.

Major Code

A...Pre-Dentistry
B...Pre-Engineering
C...Pre-Law
D...Pre-Medicine
M...Medical Technology
P...Parish Work
S...Social Work
T...Theology

COLLEGE OF PROFESSIONAL STUDIES

School of Education

Please note: If a student is preparing to teach in two areas, code to the highest level of preparation. If the academic major is not known, code:

100 Primary
200 Elementary
300 Junior High
400 Senior High

Art

102 Primary
202 Elementary
302 Junior High
402 Senior High

Chemistry

111 Primary
211 Elementary
311 Junior High
411 Senior High

English

123 Primary
223 Elementary
323 Junior High
423 Senior High

Biology

105 Primary
205 Elementary
305 Junior High
405 Senior High

Communication Arts

115 Primary
215 Elementary
315 Junior High
415 Senior High

French

126 Primary
226 Elementary
326 Junior High
426 Senior High

Business Education

408 Senior High

Earth Sciences

116 Primary
216 Elementary
316 Junior High
416 Senior High

German

138 Primary
238 Elementary
338 Junior High
438 Senior High

History

447 Senior High

Language Arts

151 Primary
251 Elementary
351 Junior High
451 Senior High

Mathematics

156 Primary
256 Elementary
356 Junior High
456 Senior High

Music

159 Primary
259 Elementary
359 Junior High
459 Senior High

Physical Education

170 Primary
270 Elementary
370 Junior High
470 Senior High

Physics

371 Junior High
471 Senior High

Political Science

474 Senior High

Science General

183 Primary
283 Elementary
383 Junior High
483 Senior High

Social Science

185 Primary
285 Elementary
385 Junior High
485 Senior High

Sociology

486 Senior High

Spanish

189 Primary
289 Elementary
389 Junior High
489 Senior High

SCHOOL OF FINE ARTS

502 Art
515 Communication Arts
559 Music

SCHOOL OF NURSING

665 Nursing

SCHOOL OF BUSINESS ADMINISTRATION

708 Business Administration

GRADUATE

900 Major Unknown

Education--999 (Specific Area Unknown)

955 School Librarian
965 School Nurse Certificate
993 Teacher Corps Elementary
994 School Administration
995 Counseling & Guidance
996 Elementary Classroom Teaching
997 Secondary Classroom Teaching
998 5th Year Certificate

Humanities--901 (Specific Area Unknown)

902 Art
914 Classical Languages
915 Communication Arts
923 English
926 French
938 German
959 Music
968 Philosophy
980 Religion

Social Sciences--916 (Specific Area Unknown)

917 Economics
947 History
974 Political Science
977 Psychology
986 Sociology

Natural Sciences--904 (Specific Area Unknown)

905 Biology
911 Chemistry
956 Mathematics
971 Physics
983 Science General

Business Administration

908 Business Administration

STUDENT MOTOR VEHICLE REGULATIONS

GENERAL INFORMATION:

Each student must complete a vehicle registration card, whether or not he is registering a vehicle.

The University suggests to all students that there is normally no requirement for on-campus students to maintain private vehicles while in attendance at Pacific Lutheran University. However, in case you are working or living off campus or if there is other special need for a vehicle, strict compliance with the following regulations will be enforced.

REGISTRATION OF VEHICLES:

All students who bring cars or other motorized vehicles to the campus must register them with the Security Office. Any unregistered vehicle on campus property is subject to "tow away"; the tow away fee is payable by the owner of the vehicle.

Registration Fees are as Follows:

1st car	\$10.00
2nd car	5.00
3rd car & additional	2.00
Part-time & Night	3.00

Decal will be good from September to September.

DECALS:

Pick up your decal at the Security Office. Temporary decals may be acquired in the Security Office for replacement vehicles, loaners, etc., without charge. During registration week there will be a period of grace so students will have proper time to register vehicles. This is done in order to save embarrassment or loss of revenue to the student.

CAMPUS PARKING AREAS:

For students who are not using their vehicles daily it is desired that full use be made of the lots available on lower campus so that commuters may make use of the parking spaces available on upper campus. In the past, residents of 121st Street between Park Avenue and "I" Street have complained because their driveways and mail boxes were blocked. In order to maintain good community relations, we must employ all means available to prevent hardships and inconveniences to our neighbors. If there are any questions, feel free to call Security, extension 247, at any time.

Sheridan

"L"

"J"

"I"

NORTH-WEST LOT

Yakima

HEALTH CENTER LOT

WEST ADMIN. LOT

EAST ADMIN. LOT

1/21st

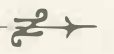

TRINITY LUTHERAN CHURCH

Wheeler

LIBRARY LOT

Garfield

HARSTAD LOT

1/22nd

UNIVERSITY CENTER LOT

1/23rd

1/24th

1/25th

Park Ave.

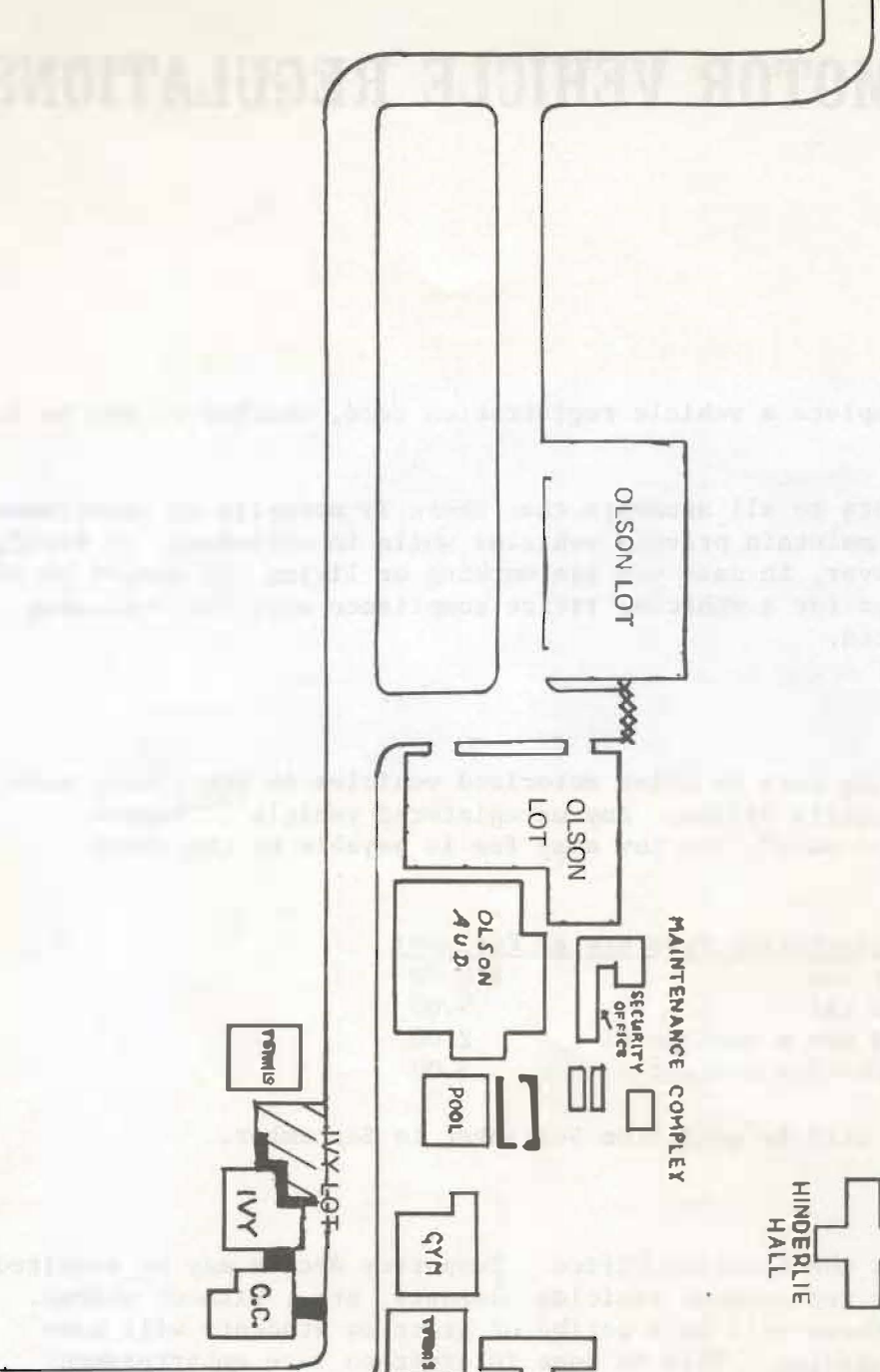
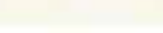
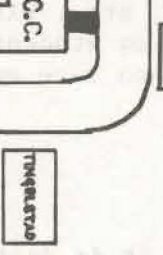
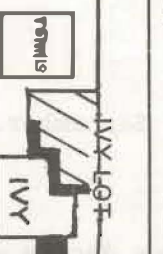
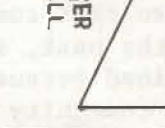
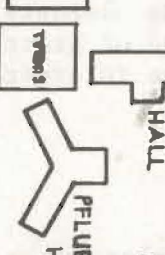
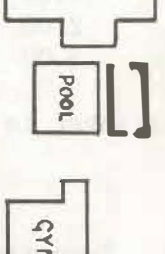
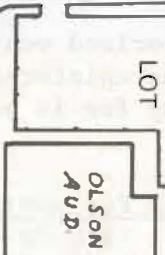
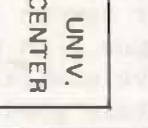
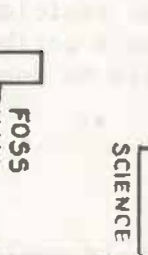
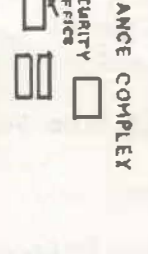
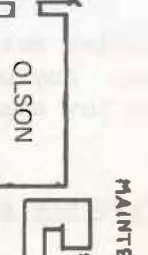
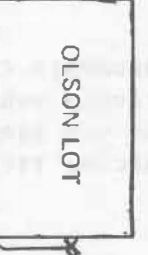
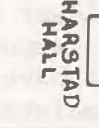
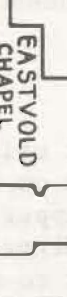
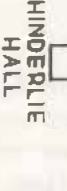
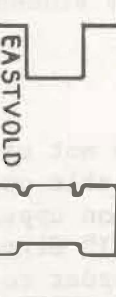
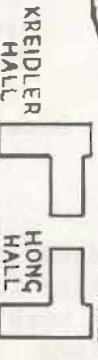
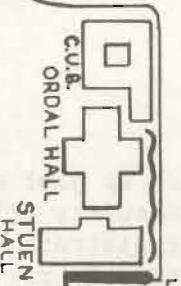
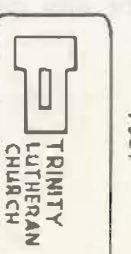
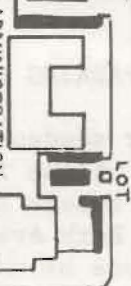
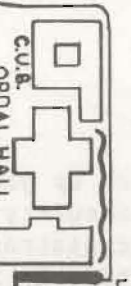
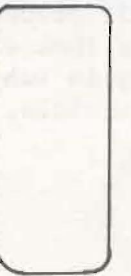
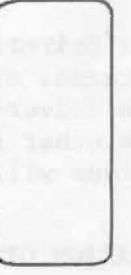
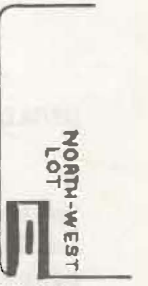
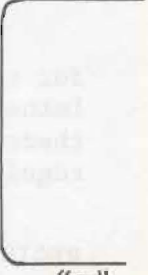

STUDENT PARKING AREAS



Reserved Parking



XXXXX Visitors Parking

September 15, 1970
(Supersedes all previous regulations)

Not to Scale

Certain courses contain a lecture, a lab., a discussion session, or various combinations of the three. Registration for these courses are usually processed by lab. or discussion section.

The System Code Number will determined how it is processed. Indicate the SCN for the lab. or discussion section desired.

ATTENDANCE IS REQUIRED IN ALL PORTIONS OF THE COURSE.

THIS CLASS SCHEDULE INDICATES WHICH HOURS AND ROOMS HAVE BEEN RESERVED FOR MEETINGS OF INDIVIDUAL CLASSES. THE MEETINGS WILL TYPICALLY BE CONFINED TO THE TIMES AND PLACES INDICATED, BUT IN KEEPING WITH ANNOUNCED FLEXIBILITY AND INDIVIDUALITY IN THE CONDUCT OF STUDIES AT THE UNIVERSITY, THE NUMBER OF POSSIBLE CLASS MEETINGS UTILIZED PER WEEK MAY VARY FROM COURSE TO COURSE, OR FROM WEEK TO WEEK WITHIN ANY ONE COURSE. WHERE FORMAL CONTACT HOURS ARE REDUCED, IT IS EXPECTED THAT THE INSTRUCTOR WILL PROVIDE MORE OPPORTUNITY FOR INFORMAL CLASS CONTACT, E.G., THROUGH INDIVIDUAL OR SMALL GROUP MEETINGS WITH HIS STUDENTS.

AEROSPACE

TIMES AND COURSES ARE TO BE ARRANGED WITH THE UNIVERSITY OF PUGET SOUND.

SYSTEM CODE NUMBER

497 ↓ RESEARCH IN ART HISTORY - 1 COURSE
INDEPENDENT STUDY CARD REQUIRED FOR THIS COURSE.
9595 TO BE ARRANGED

SYSTEM CODE NUMBER

ART

110	↓	THE VISUAL ARTS - 1 COURSE					
0424		THRF 230	A-204	KITTLESON L			
160		PICTORIAL DESIGN - 1 COURSE					
0426		MTWR 130 - 320	CUB	SCHWIDDER E			
230		CERAMICS I - 1 COURSE					
0428		SEC A MTWR 1030-1220	ABB	KEYES D			
0434		SEC B M W 630 - 920	ABB	KEYES D			
235		MATERIALS DESIGN - 1 COURSE					
0436		MTWR 750 - 940	AB	ELWELL G			
260		LIFE DRAWING - 1 COURSE					
0438		MTWR 130 - 320	CUB	ACHEPOHL K			
326		FILM MAKING WORKSHOP - 1 COURSE					
0444		MTWR 130 - 320	A-105	ELWELL G			
330		CERAMICS II - 1 COURSE					
0446		SEC A MTWR 1030-1220	ABB	KEYES D			
0448		SEC B M W 630	ABB	KEYES D			
338		GLASS BLOWING - 1 COURSE					
0504		MTWR 750 - 940	CUB	KEYES D			
341		ART EDUCATION - ELEMENTARY - 1/2 COURSE					
0506		SEC A M W 130 - 320	AB	ROSKOS G			
0508		SEC B T R 130 - 320	AB	ROSKOS G			
0514		SEC C R 630 - 920	AB	ELWELL G			
350		SCULPTURE - 1 COURSE					
0516		MTWR 330 - 520	AB	ROSKOS G			
365		PAINTING - 1 COURSE					
0518		MTWR 1030-1220	CUB	TOMSIK W			
370		PRINTMAKING - 1 COURSE					
0524		MTWR 750 - 940	A-105	ACHEPOHL K			
380		IMAGERY AND SYMBOLISM - 1 COURSE					
0526		MTWR 330	CUB	SCHWIDDER E			
384		RENAISSANCE ART - 1 COURSE					
0528		THRF 1230	CUB	KITTLESON L			
440		SEMINAR IN SECONDARY ART EDUCATION - 1/2 COURSE					
0534		T 630 - 920	AB	ROSKOS G			
492		STUDIO PROJECTS - 1 COURSE					
9595		TO BE ARRANGED					
		INDEPENDENT STUDY CARD REQUIRED FOR THIS COURSE.					

BIOLOGY

111		BIOLOGY AND MODERN MAN - 1 COURSE					
0618		MTWR 230	A-101	KNUDSEN J			
		PART OF ENVIRONMENTAL STUDIES SEMESTER. SEE CROSS REFERENCED COURSES.					
152		CELL BIOLOGY - 1 COURSE					
		M WRF 1130	A-101	BOHANNON R			
0624		LAB A M 230 - 520	R-210	BOHANNON R			
0626		LAB B T 130 - 420	R-210	BOHANNON R			
0628		LAB C W 230 - 520	R-210	BOHANNON R			
0634		LAB D R 130 - 420	R-210	GEE A			
162		HUMAN ANATOMY AND PHYSIOLOGY - 1 COURSE					
		M W F 850	A-101	JENSEN J			
0636		LAB A T 1030- 120	R-211	JENSEN J			
0638		LAB B T 130 - 420	R-211	SORENSEN R			
0644		LAB C W 1030- 120	R-211	SORENSEN R			
0646		LAB D R 1030- 120	R-211	JENSEN J			
0648		LAB E R 130 - 420	R-211	SORENSEN R			
		DIS A T 850	R-108	JENSEN J			
		DIS B R 850	R-108	JENSEN J			
		CONTACT THE DEPARTMENT FOR DISCUSSION GROUP ASSIGNMENT					
222		CONSERVATION OF NATURAL RESOURCES - 1/2 COURSE					
0704		R 430	R-108	OSTENSON B			
		PART OF ENVIRONMENTAL STUDIES SEMESTER. SEE CROSS REFERENCED COURSES.					
251		DEVELOPMENTAL BIOLOGY - 1 COURSE					
		M W F 1230	R-108	LERAAS H			
0706		LAB A M W 1030-1220	R-209	CRESO J			
0708		LAB B M W 130 - 320	R-209	SORENSEN R			
0714		LAB C T R 750 - 940	R-209	LERAAS H			
321		ORNITHOLOGY - 1/2 COURSE					
0716		S 850 -1150	R-203	OSTENSON B			
324		NATURAL HISTORY OF VERTEBRATES - 1 COURSE					
0718		M W F 1130	R-203	HEYER			
		LAB M W 330 - 520	R-203				
331		GENETICS - 1 COURSE					
		M W F 1230	A-101	GEE A			
0724		LAB A M 130 - 420	R-207	GEE A			
0726		LAB B W 130 - 420	R-207	GEE A			
0728		LAB C F 130 - 420	R-207	GEE A			

SYSTEM CODE NUMBER

340	↓	SYSTEMATIC BOTANY - 1 COURSE					
0734		T 1230	R-203	CRESO I			
		LAB T R 130 - 320	R-203				
346		CELLULAR PHYSIOLOGY - 1 COURSE					
0736		M W F 1030	R-203	JENSEN J BOHANNON R			
		LAB IS OPTIONAL - SEE BIOLOGY 347 BELOW					
347		CELLULAR PHYSIOLOGY LABORATORY - 1/4 COURSE					
0738		R 1230- 420	R-207	BOHANNON R JENSEN J			
		IF BIOLOGY 347 IS ELECTED, BIOLOGY 346 MUST ALSO BE TAKEN					
361		COMPARATIVE ANATOMY - 1 COURSE					
0744		M W F 850	R-203	LERAAAS H			
		LAB M W 130 - 320	R-211	LERAAAS H			
425		BIOLOGICAL OCEANOGRAPHY - 1 COURSE					
0746		T R 850	R-210	KNUDSEN J			
		LAB T R 1030-1220	R-210	KNUDSEN J			
490		SEMINAR - 1/2 COURSE					
0748		T 430 - 620	R-108	HEYER			
		PERMISSION OF INSTRUCTOR REQUIRED					
491		INDEPENDENT STUDY - 1/4 TO 1/2 COURSE					
9595		TO BE ARRANGED INDEPENDENT STUDY CARD REQUIRED FOR THIS COURSE.					
597		GRADUATE RESEARCH - 1/2 TO 1 COURSE					
9595		TO BE ARRANGED INDEPENDENT STUDY CARD REQUIRED FOR THIS COURSE.					

BUSINESS ADMINISTRATION

241		BUSINESS COMMUNICATIONS - 1 COURSE					
0836		M R 750 - 940	A-221				
281		FINANCIAL ACCOUNTING - 1 COURSE					
0838		M R 750 - 940	A-210	GRAHAM J			
282		ACCOUNTING INFORMATION SYSTEMS - 1 COURSE					
0844		SEC A M R 750 - 940	A-217	BEARSE			
0846		SEC B M R 230 - 420	A-217	BEARSE			
0848		SEC C M R 700	A-217	BEARSE			
290		LAW AND SOCIETY - 1 COURSE					
0904		T F 750 - 940	A-210	LAUER A			
364		MANAGERIAL FINANCE - 1 COURSE					
0906		M R 1030-1220	A-217	WATKINSON W			
365		REAL ESTATE - 1 COURSE					
0908		M R 1030-1220	A-221	PETERSON C			
370		MARKETING SYSTEMS - 1 COURSE					
0914		T F 750 - 940	A-221	MC MASTER K			
383		INCOME TAXATION - 1 COURSE					
0916		M R 230 - 420	A-221	PETERSON C			
441		TEACHING SECRETARIAL SUBJECTS - 1/2 COURSE					
0918		R 700	L-106	NICHOLSON			
453		PERSONNEL AND INDUSTRIAL RELATIONS - 1 COURSE					
0924		SEC A T F 1030-1220	A-217	STINTZI V			
0926		SEC B R 700	A-211	STINTZI V			
455		BUSINESS POLICY - 1 COURSE					
0928		M R 1230- 220	A-221	HUTCHEON W			
456		HONORS SEMINAR - 1 COURSE					
0934		M 700	A-223	HUTCHEON W			
461		FINANCIAL ANALYSIS - 1 COURSE					
0936		W 700	A-210	WATKINSON W			
471		MARKETING RESEARCH AND CONSUMER BEHAVIOR - 1 COURSE					
0938		T F 1030-1220	A-221	MC MASTER K			
473		INDUSTRIAL MARKETING AND PURCHASING - 1 COURSE					
0944		M R 1030-1220	A-227	MARTILLA J			
482		ADVANCED ACCOUNTING - 1 COURSE					
0946		T F 1230- 220	A-221	ZULAUF D			
484		AUDITING - 1 COURSE					
0948		R 700	A-223	GRAHAM J			
488		SYSTEMS ANALYSIS AND DESIGN - 1 COURSE					
1404		T F 330 - 940	A-217	ZULAUF D			
495		BUSINESS LAW - 1 COURSE					
1406		T 700	A-210	LAUER A			
550		ORGANIZATIONAL ENVIRONMENT - 1 COURSE					
1408		M 700	A-221	KING G			
551		SEMINAR IN INDUSTRIAL MANAGEMENT - 1 COURSE					
1414		T 700	A-221	STINTZI V			

SYSTEM CODE NUMBER

555	↓	BUSINESS STRATEGY AND POLICY - 1 COURSE					
1416		R 700	A-221	HUTCHEON W			
564		SEMINAR IN FINANCIAL MANAGEMENT - 1 COURSE					
1418		M 700	A-210	WATKINSON W			
570		SEMINAR IN MARKETING MANAGEMENT - 1 COURSE					
1424		W 700	A-221	MARTILLA J			
582		ACCOUNTING INFORMATION AND CONTROL - 1 COURSE					
1426		W 700	A-217	ZULAUF D			
596		RESEARCH COLLOQUIUM - 1 COURSE					
1428		M 600 - 750	L-106	MARTILLA J			

CHEMISTRY

104		GENERAL INORGANIC CHEMISTRY - 1 COURSE					
1516		M W F 130	R-307	GIODINGS W			
		LAB T 1030-1220	R-314				
131		PRINCIPLES OF CHEMISTRY - 1 COURSE					
		M W F 850	R-307	SWANK D			
		BY DEPARTMENTAL INVITATION ONLY.					
142		SYSTEMATIC INORGANIC CHEMISTRY - 1 COURSE					
		M W F 850	R-108	OLSEN R			
1524		LAB A M 130 - 420	R-314				
1526		LAB B T 230 - 520	R-314				
1528		LAB C W 230 - 520	R-314				
1534		LAB D R 130 - 420	R-314				
332		ORGANIC CHEMISTRY - 1 COURSE					
1536		M W F 750	R-108	HUESTIS L			
		CHEMISTRY 332 AND 334 MUST BE TAKEN CONCURRENTLY					
334		ORGANIC CHEMISTRY LABORATORY - 1/4 COURSE					
1538		LAB A T 100 - 520	R-301	HUESTIS L			
1544		LAB B W 100 - 520	R-301	NESSET B			
1546		LAB C R 100 - 520	R-301	NESSET B			
		CHEMISTRY 332 AND 334 MUST BE TAKEN CONCURRENTLY					
342		PHYSICAL CHEMISTRY - 1 COURSE					
1548		MTWR 1130	R-307	TOBIASON F			
344		PHYSICAL CHEMISTRY LABORATORY - 1/4 COURSE					
1604		LAB A T 130 - 520	R-302	TOBIASON F			
1606		LAB B R 130 - 520	R-302	TOBIASON F			
404		BIOCHEMISTRY - 1 COURSE					
1608		MTWR 750	R-307	NESSET B			
		LAB W 130 - 420	R-301				
422		ADVANCED INORGANIC CHEMISTRY - 1 COURSE					
1614		MTWR 1030	R-307	SWANK D			
		LAB M 130 - 420	R-312				
491		INDEPENDENT STUDY - 1/4, 1/2 OR 1 COURSE					
9595		TO BE ARRANGED INDEPENDENT STUDY CARD REQUIRED FOR THIS COURSE.					
497		RESEARCH - 1/2 OR 1 COURSE					
9595		TO BE ARRANGED INDEPENDENT STUDY CARD REQUIRED FOR THIS COURSE.					
597		GRADUATE RESEARCH - 1/2 TO 1 COURSE					
9595		TO BE ARRANGED INDEPENDENT STUDY CARD REQUIRED FOR THIS COURSE.					

COMMUNICATION ARTS

123		FUNDAMENTALS OF ORAL COMMUNICATION - 1 COURSE					
		M 130	A-101	KARL T			
1648		DIS A TWRF 750	E-122				
1704		DIS B TWRF 850	E-123				
1706		DIS C TWRF 230	E-122				
1708		DIS D TWRF 130	E-123				
1714		DIS E MTWR 330	E-122				
1716		DIS F T R 430 - 550	E-123				
125		FORENSICS - 1/4 COURSE					
1726		M W 430	E-123	KARL T			
225		FORENSICS - 1/4 COURSE					
1728		M W 430	E-123	KARL T			
226		PARLIAMENTARY LAW - 1/2 COURSE					
1734		M 700	E-122	KARL T			
232		CONTEMPORARY ORAL DISCOURSE - 1 COURSE					
1736		MTWR 850	E-122	CAPP G			
241		INTERPRETIVE READING - 1 COURSE					
1738		MTWRF 1030	E-123	PARKER W			

SYSTEM CODE NUMBER

250	↓	FUNDAMENTALS OF ACTING - 1 COURSE				
1744		MTWRF 1130-120	E-123	PARKER W		
284		NEWS WRITING - 1/2 COURSE				
1746		R 430-550	A-210	EYRES		
325		FORENSICS - 1/4 COURSE				
1748		M W 430	E-123	KARL T		
327		EXTEMPORANEOUS SPEAKING - 1 COURSE				
1804		MTWRF 1130	E-122	KARL T		
335		AMERICAN PUBLIC ADDRESS - 1 COURSE				
1806		MTWR 130	E-122	REVIS M		
344		ADVANCED INTERPRETATION - 1 COURSE				
1808		MTWRF 1030	E-122	KARL T		
352		SCENIC DESIGN - 1 COURSE				
1814		M W 230-420	E-123	NORHOLM E		
		T RF 330	E-123			
374		TELEVISION PRODUCTION - 1 COURSE				
1816		T R 230-420	T V STUDIO	DOUGHTY J		
		M W F 330	T V STUDIO			
385		EDITORIAL TECHNIQUES - LABORATORY - 1/2 COURSE				
1818		TO BE ARRANGED		EYRES		
425		FORENSICS - 1/4 COURSE				
1826		M W 430	E-123	KARL T		
474		TELEVISION AND THE CLASSROOM TEACHER - 1/2 COURSE				
1828		TWR 1230	A-213	DOUGHTY J		
491		SPECIAL STUDIES IN COMMUNICATION ARTS - 1/4 COURSE				
9595		TO BE ARRANGED				
		INDEPENDENT STUDY CARD REQUIRED FOR THIS COURSE.				
492		SPECIAL STUDIES IN COMMUNICATION ARTS - 1/2 COURSE				
9595		TO BE ARRANGED				
		INDEPENDENT STUDY CARD REQUIRED FOR THIS COURSE.				
493		SPECIAL STUDIES IN COMMUNICATION ARTS - 1 COURSE				
9595		TO BE ARRANGED				
		INDEPENDENT STUDY CARD REQUIRED FOR THIS COURSE.				
596		RESEARCH IN COMMUNICATION ARTS - 1/4 COURSE				
9595		TO BE ARRANGED				
		INDEPENDENT STUDY CARD REQUIRED FOR THIS COURSE.				
597		RESEARCH IN COMMUNICATION ARTS - 1/2 COURSE				
9595		TO BE ARRANGED				
		INDEPENDENT STUDY CARD REQUIRED FOR THIS COURSE.				
598		RESEARCH IN COMMUNICATION ARTS - 1 COURSE				
9595		TO BE ARRANGED				
		INDEPENDENT STUDY CARD REQUIRED FOR THIS COURSE.				

EARTH SCIENCES

132		HISTORICAL GEOLOGY - 1 COURSE				
		M W F 1030	MEM GYM CLSRM	LOWES B		
1916		LAB A T 130-420	MEM GYM CLSRM			
1918		LAB B F 130-420	MEM GYM CLSRM			
202		GENERAL OCEANOGRAPHY - 1 COURSE				
		MTW F 750	A-101	OSTENSON B		
1924		LAB A M 130-320	MEM GYM CLSRM			
1926		LAB B R 130-320	MEM GYM CLSRM			
324		PETROLOGY - 1 COURSE				
1928		M W F 850	MEM GYM CLSRM	LOWES B		
		LAB W 130-420	MEM GYM CLSRM			
490		ENVIRONMENTAL SEMINAR - 1 COURSE				
1934		T 330-520	O-103	OSTENSON B		
		PART OF ENVIRONMENTAL STUDIES SEMESTER.				
		SEE CROSS REFERENCED COURSES.				
491		INDEPENDENT STUDY - 1/4 TO 1 COURSE				
9595		TO BE ARRANGED				
		INDEPENDENT STUDY CARD REQUIRED FOR THIS COURSE.				

ECONOMICS

150		PRINCIPLES OF ECONOMICS - 1 COURSE				
2404		SEC A MTWRF 1030	A-211	GENDA R		
2406		SEC B MTWRF 130	A-211	JENSEN R		
352		INTERMEDIATE MICRO ECONOMIC ANALYSIS - 1 COURSE				
2408		MTWRF 1130	A-211	VINJE D		
361		MONEY AND BANKING - 1 COURSE				
2414		MTWRF 1030	A-115	ENDERBY M		

SYSTEM CODE NUMBER

432	↓	DEVELOPMENT ECONOMICS - 1 COURSE				
2416		T R 330-520	A-206	VINJE D		
481		STATISTICAL METHODS - 1 COURSE				
		SEE CROSS REFERENCED COURSES				
486		READINGS IN THE EVOLUTION OF ECONOMIC THOUGHT - 1 COURSE				
2418		MTWRF 230	A-211	ENDERBY M		
490		SEMINAR - 1 COURSE				
2424		M W 330-450	A-215	GENDA R		
		ECONOMICS MAJORS WHO ARE SENIORS,				
		OTHERS WITH CONSENT OF THE INSTRUCTOR.				
491		INDEPENDENT STUDY - 1/4 TO 1 COURSE				
9595		TO BE ARRANGED				
		AVAILABLE ON PASS FAIL ONLY				
		INDEPENDENT STUDY CARD REQUIRED FOR THIS COURSE.				
501		A MULTIDISCIPLINE APPROACH TO THE TEACHING				
		OF SOCIAL STUDIES - 1 COURSE				
2426		W 700	A-213	GENDA R		
543		QUANTITATIVE METHODS - 1 COURSE				
2428		T R 630-820	A-215	MILLER M		
591		INDEPENDENT STUDY - 1/4 TO 1 COURSE				
9595		TO BE ARRANGED				
		AVAILABLE ON PASS FAIL ONLY				
		INDEPENDENT STUDY CARD REQUIRED FOR THIS COURSE.				
599		THESIS - 1/4 TO 1 COURSE				
9595		TO BE ARRANGED				
		AVAILABLE ON PASS FAIL ONLY				
		INDEPENDENT STUDY CARD REQUIRED FOR THIS COURSE.				

EDUCATION

A STUDENT MUST HAVE A GRADE POINT AVERAGE OF 2.25 TO BE ELIGIBLE TO REGISTER FOR ANY COURSES IN THE SCHOOL OF EDUCATION. ANY EXCEPTION MUST BE APPROVED BY THE DEAN OF THE SCHOOL OF EDUCATION.

201		LEARNER AND SOCIETY - GROWTH AND DEVELOPMENT - 1 COURSE				
		* A GPA OF 2.15 IS ACCEPTABLE FOR EDUCATION 201 *				
2516		SEC A MTWR 850-1120	A-204	PETTY R		
		SECONDARY ONLY. INCLUDES FIELD OBSERVATION				
		AND DISCUSSION GROUPS.				
2518		SEC B MTWR 850-1120	A-207	WILLIAMSON J		
		ELEMENTARY ONLY. INCLUDES FIELD OBSERVATION				
		AND DISCUSSION GROUPS.				
321		HUMAN DEVELOPMENT - 1 COURSE				
2524		T R 330-520	A-204	WILLIAMSON J		
		LAB R 850-1120	PUBLIC SCHOOL			
322		GENERAL METHODS - PRIMARY - 1 COURSE				
2526		SEC A MTWRF 850-1120	A-207	MATHERS M		
2528		SEC B MTWRF 1230-220	A-115	MATHERS M		
323		GENERAL METHODS - UPPER ELEMENTARY - 1 COURSE				
2534		MTWRF 850-1120	A-117	ORVIK F		
325		THE TEACHING OF READING - ELEMENTARY - 1 COURSE				
2536		SEC A MT RF 1130	A-117	NAPJUS A		
2538		SEC B MT RF 330	A-115	NAPJUS A		
326		THE TEACHING OF ARITHMETIC - 1/2 COURSE				
2544		SEC A M W F 130	A-215	DE BOWER C		
2546		SEC B T 430-620	A-215	DE BOWER C		
		PREREQUISITE - MATH 323				
408		LANGUAGE ARTS IN THE ELEMENTARY SCHOOL - 1/2 COURSE				
2548		T 430	A-117	ORVIK F		
410		SCIENCE IN THE ELEMENTARY SCHOOL - 1/2 COURSE				
2604		R 430	A-117	STEIN L		
420		THE TEACHING OF READING - SECONDARY - 1/2 COURSE				
2606		MT RF 130	A-206	NAPJUS A		

PROFESSIONAL SEMESTER (PERIODS 1-7) SECONDARY ONLY. TO BE TAKEN CONCURRENTLY WITH OTHER PROFESSIONAL SEMESTER COURSES EDUCATION 423 AND 434. THE PROFESSIONAL SEMESTER SHOULD BE TAKEN AS A COMPLETE UNIT AND SHOULD NOT BE FRAGMENTED.

423		GENERAL METHODS - SECONDARY - 1 COURSE				
2624		MTWRF 1030-1220	A-200			
		MTWRF 230	A-115			

PROFESSIONAL SEMESTER (PERIODS 1-7) SECONDARY ONLY. TO BE TAKEN CONCURRENTLY WITH OTHER PROFESSIONAL SEMESTER COURSES EDUCATION 420 AND 434. THE PROFESSIONAL SEMESTER SHOULD BE TAKEN AS A COMPLETE UNIT AND SHOULD NOT BE FRAGMENTED.

SYSTEM CODE NUMBER

430	↓	STUDENT TEACHING - PRIMARY - 2 1/2 COURSES					
2644		DAILY					
432		STUDENT TEACHING - UPPER ELEMENTARY - 2 1/2 COURSES					
2714		DAILY					
434		STUDENT TEACHING - SECONDARY - 2 1/2 COURSES					
2734		OLD PROGRAM SEC A DAILY					
434		STUDENT TEACHING - SECONDARY - 2 COURSES					
2804		SEC B DAILY					
<p>PROFESSIONAL SEMESTER (PERIODS 1-7) SECONDARY ONLY. TO BE TAKEN CONCURRENTLY WITH OTHER PROFESSIONAL SEMESTER COURSES EDUCATION 420 AND 423. THE PROFESSIONAL SEMESTER SHOULD BE TAKEN AS A COMPLETE UNIT AND SHOULD NOT BE FRAGMENTED.</p>							
435		PROFESSIONAL SEMINAR - 1/2 COURSE					
2824		PRIMARY SEC A T R 130 - 320	A-117	MATHERS M			
2826		UPPER ELEMENTARY SEC B T R 130 - 320	A-117	ORVIK F			
444		ENGLISH IN THE SECONDARY SCHOOL - 1/2 COURSE					
2828		H 430	A-115	BAUGHMAN M			
453		PROCESSING SCHOOL LIBRARY MATERIALS - 1/2 COURSE					
2834		W 430	L-106	EHLERS			
455		INSTRUCTIONAL MATERIALS - 1/2 COURSE					
2836		R 430	A-115	HAGEN A			
457		PREPARATION AND UTILIZATION OF INSTRUCTIONAL MATERIALS-3/4 COURSE					
2838		W 330	GRAPHICS LAB	STEIN L			
461		GROUP PROCESSES AND THE INDIVIDUAL - 1/2 COURSE					
2844		T 130 - 320	IVY LOUNGE	FLETCHER J			
463		GUIDANCE IN THE ELEMENTARY SCHOOL - 1/2 COURSE					
2846		R 430	A-215	WILLIAMSON J			
465		GUIDANCE IN THE SECONDARY SCHOOL - 1/2 COURSE					
2848		M 700	A-202	BERTNESS			
467		EVALUATION - 1/2 COURSE					
2904		W 430	A-117	LAUER			
468		EDUCATIONAL PSYCHOLOGY - 1 COURSE					
2906		T R 430	A-221	FLETCHER J			
473		PARENT-TEACHER CONFERENCE - 1/2 COURSE					
2908		R 430	A-217	KEBLBEK			
481		STATISTICAL METHODS - 1 COURSE					
SEE CROSS REFERENCED COURSES							
497		SPECIAL PROJECT - 1/4 TO 1 COURSE					
9595		TO BE ARRANGED MUST BE APPROVED AND SCHEDULED BY PROJECT SUPERVISOR. INDEPENDENT STUDY CARD REQUIRED FOR THIS COURSE.					
501		A MULTIDISCIPLINE APPROACH TO THE TEACHING OF SOCIAL STUDIES - 1 COURSE					
2928		W 700	A-223	GENDA R			
545		METHODS AND TECHNIQUES OF RESEARCH - 1/2 COURSE					
2934		T 700	A-217	LAUER			
550		SCHOOL FINANCE - 1/2 COURSE					
2936		R 700	A-117	GRAY			
558		ADMINISTRATIVE INTERNSHIP - 1/2 TO 1 COURSE					
9595		TO BE ARRANGED INDEPENDENT STUDY CARD REQUIRED FOR THIS COURSE.		JOHNSTON K			
560		CONTINUING PRACTICUM - 1 COURSE					
2946		M 330 - 520	A-109	JORGENSEN R			
561		COUNSELING THEORY AND PRACTICE - 1 COURSE					
2948		M W 430	A-211	FLETCHER J			
563		PRACTICUM IN GROUP PROCESS AND LEADERSHIP - 1/2 COURSE					
3404		R 700 - 990	A-115	FLETCHER J			
MASTERS CANDIDATES IN COUNSELING, GUIDANCE AND STUDENT PERSONNEL WORK WILL RECEIVE PRIORITY.							
570		PRACTICUM AND FIELD WORK IN COUNSELING AND GUIDANCE - 1 COURSE					
3406		M 330 - 520	A-109	JORGENSEN R			
MASTERS CANDIDATES IN COUNSELING AND GUIDANCE ONLY							
571		HISTORY AND PHILOSOPHY OF HIGHER EDUCATION - 1 COURSE					
3408		TO BE ARRANGED		LEASURE			
572		PRACTICUM IN STUDENT PERSONNEL WORK - 1 COURSE					
3414		TO BE ARRANGED		BEAL P LEASURE			
573		STUDENT PERSONNEL WORK IN HIGHER EDUCATION - 1 COURSE					
3416		TO BE ARRANGED		BEAL P			
575		MENTAL HEALTH - 1/2 COURSE					
3428		T 700	A-115	FLETCHER J			

SYSTEM CODE NUMBER

590	↓	GRADUATE SEMINAR - 0 CREDIT					
3434		M 700	A-115	LAUER			
NO CHARGE FOR THIS COURSE							
596		RESEARCH STUDIES IN EDUCATION - 1/4 COURSE					
9595		TO BE ARRANGED WITH MAJOR ADVISER INDEPENDENT STUDY CARD REQUIRED FOR THIS COURSE.					
597		RESEARCH STUDIES IN EDUCATION - 1/2 COURSE					
9595		TO BE ARRANGED WITH MAJOR ADVISER INDEPENDENT STUDY CARD REQUIRED FOR THIS COURSE.					
599		THESIS - 3/4 TO 1 COURSE					
9595		TO BE ARRANGED WITH MAJOR ADVISER INDEPENDENT STUDY CARD REQUIRED FOR THIS COURSE.					

ENGLISH

101		COMPOSITION - 1 COURSE					
3518		SEC A T R 1030	G-106	JONES R			
3524		SEC B M W 850	A-223	KLOPSCH R			
3526		SEC C M W 1030	X-112	BENTON P			
3528		SEC D M W 1130	A-208	BLOMQUIST G			
3534		SEC E T R 1230	A-206	RIEMER M			
3536		SEC F W F 750	A-217	VAN TASSEL O			
217		SHORT STORY - 1 COURSE					
3546		T R 130 - 320	A-212	REIGSTAD P			
218		ADVANCED COMPOSITION - 1 COURSE					
3548		M W F 1130	X-203	JOHNSON L			
230		INTRODUCTION TO CONTEMPORARY LITERATURE - 1 COURSE					
3604		M W 130 - 320	A-207	JONES R			
		F 130	A-207				
252		INTRODUCTION TO ENGLISH LITERATURE - AFTER 1750 - 1 COURSE					
3606		M W F 850	A-206	REIGSTAD P			
323		CHILDRENS LITERATURE - 1 COURSE					
3608		M W 430	A-200	BLOMQUIST G			
349		MODERN POETRY - 1 COURSE					
3614		M 700	A-208	JONES R			
388		ENGLISH LITERATURE - SEVENTEENTH CENTURY - 1 COURSE					
3616		T R F 1230	X-203	JOHNSON L			
389		ENGLISH LITERATURE - EIGHTEENTH CENTURY - 1 COURSE					
3618		T R 430	A-202	KLOPSCH R			
391		ENGLISH LITERATURE - THE VICTORIAN AGE - 1 COURSE					
3624		M W F 750	A-200	VAN TASSEL O			
STUDENTS MUST RESERVE THURSDAYS 1230 FOR CONFERENCE.							
441		THE AMERICAN RENAISSANCE - 1830-1870 - 1 COURSE					
3626		M W F 750	A-206	BENTON P			
443		AMERICAN LITERATURE SINCE 1920 - 1 COURSE					
3628		M W F 130	A-202	BENTON P			
491		INDEPENDENT READING AND RESEARCH - 1/2 COURSE					
9595		TO BE ARRANGED INDEPENDENT STUDY CARD REQUIRED FOR THIS COURSE.					
597		GRADUATE RESEARCH - 1 COURSE					
9595		TO BE ARRANGED INDEPENDENT STUDY CARD REQUIRED FOR THIS COURSE.					

FOREIGN LANGUAGES

102		ELEMENTARY LANGUAGE - 1 COURSE					
FRENCH							
3708		SEC A M T W R F 750	A-208	WOLTER M			
3714		SEC B M T W R F 850	A-212	MONROE K			
3716		SEC C M T W R F 1030	X-203	MONROE K			
GERMAN							
3718		SEC E M T W R F 750	A-212	SWENSON R			
3724		SEC F M T W R F 1030	A-223	WEBSTER P			
3726		SEC G M T W R F 130	A-208	BLUBAUGH G			
GREEK							
3728		SEC I M T W R F 850	A-213	CARLETON S			
LATIN							
3734		SEC L M T W R F 1030	G-102	CARLETON S			
NORWEGIAN							
3736		SEC N M T W R F 850	X-203	TOVEN A			
3738		SEC O T R 700	A-212	TOVEN A			
SPANISH							
3744		SEC S M T W R F 750	X-203	ROBINSON G			
3746		SEC T M T W R F 1030	A-208	FAYE L			

SYSTEM CODE NUMBER

202 INTERMEDIATE LANGUAGE - 1 COURSE					
↓ FRENCH					
3748	SEC A	MT RF	850	A-208	HOLTER M
3804	SEC B	MT RF	130	A-217	PAYNE
GERMAN					
3806	SEC E	MT RF	750	A-213	WEBSTER P
3808	SEC F	MT RF	850	O-106	BLUBAUGH G
3814	SEC G	MTWR	230	X-203	WILHELM
GREEK					
3816	SEC I	MT RF	850	L-106	PETERSEN J
LATIN					
3818	SEC L	MT RF	750	A-211	CARLETON S
NORWEGIAN					
3824	SEC N	MT RF	1030	A-212	TOVEN A
SPANISH					
3826	SEC S	MT RF	130	X-203	FAYE L
352 COMPOSITION AND CONVERSATION - 1 COURSE					
↓ FRENCH					
3828	SEC A	MTW F	1230	A-212	MONROE K
GERMAN					
3834	SEC E	MT RF	1130	A-212	BLUBAUGH G
SPANISH					
3836	SEC S	TWRF	850	O-105	ROBINSON G
400 LINGUISTICS - 1 COURSE					
3838	M R		230	A-206	ROBINSON G
431 TWENTIETH CENTURY LITERATURE - 1 COURSE					
↓ SPANISH					
3844	SEC S	MT RF	1130	X-107	FAYE L
432 TWENTIETH CENTURY LITERATURE - 1 COURSE					
↓ FRENCH					
3928	SEC A	MT RF	230	L-106	PAYNE
GERMAN					
3934	SEC E	T	630 - 920	L-106	SWENSON R
445 METHODOLOGY OF TEACHING FOREIGN LANGUAGES - 1/2 COURSE					
3936	R		430	A-223	SWENSON R
491 INDEPENDENT STUDY - 1/2 TO 1 COURSE					
9595	TO BE ARRANGED INDEPENDENT STUDY CARD REQUIRED FOR THIS COURSE.				
597 GRADUATE RESEARCH - 1/2 TO 1 COURSE					
9595	TO BE ARRANGED INDEPENDENT STUDY CARD REQUIRED FOR THIS COURSE.				
JAPANESE AND RUSSIAN					
TIMES AND COURSES ARE TO BE ARRANGED WITH THE UNIVERSITY OF PUGET SOUND.					

GENERAL ENGINEERING

144 COMPUTERS AND PROGRAMMING - 1 COURSE					
4416	M R		330 - 520	A-213	LIEBELT P
152 ENGINEERING DRAWING AND DESCRIPTIVE GEOMETRY - 1/2 COURSE					
4418	T R		330 - 520	GRAPHICS LAB	YANG J
212 STATICS - 1 COURSE					
4424	M W F		1130	O-104	YANG J
346 NUMERICAL ANALYSIS - 1 COURSE					
4426	MTWRF		130	O-105	BRINK J

GEOLOGY

SEE EARTH SCIENCES

HISTORY

108 HISTORY OF CIVILIZATION - 1 COURSE					
4446	SEC A	T	750 - 940	X-201	SCHNACKENBERG W
4448	SEC B	T	1030-1220	X-201	SCHARNWEBER W

IN ADDITION TO THE TWO HOUR LECTURE, STUDENTS ARE EXPECTED TO ATTEND ONE DISCUSSION SESSION PER WEEK.

DISCUSSION GROUPS FOR SECTION A ARE SCHEDULED THURSDAY AND FRIDAY PERIODS 1 AND 2.

DISCUSSION GROUPS FOR SECTION B ARE SCHEDULED THURSDAY AND FRIDAY PERIODS 3 AND 4.

SYSTEM CODE NUMBER

251 COLONIAL AMERICAN HISTORY - 1 COURSE					
4504	M WRF		850	X-201	HALSETH J
252 NINETEENTH CENTURY AMERICAN HISTORY - 1 COURSE					
4506	M WRF		1030	X-201	MARTINSON A
253 TWENTIETH CENTURY AMERICAN HISTORY - 1 COURSE					
4508	M WRF		1130	X-201	JOHNSON D
322 HISTORY OF THE ANCIENT WORLD - 1 COURSE					
4514	M WRF		1130	A-213	CARLETON S
326 RENAISSANCE AND REFORMATION - 1 COURSE					
4516	M WRF		850	X-107	SCHARNWEBER W
337 MODERN LATIN AMERICA - 1 COURSE					
4518	M WRF		850	A-215	JOHNSON D
340 FAR EASTERN HISTORY - 1 COURSE					
4524	M		700	X-107	SCHNACKENBERG W
351 THE PACIFIC NORTHWEST - 1 COURSE					
4526	M		700	X-201	AKRE
356 AMERICAN DIPLOMATIC HISTORY - 1 COURSE					
4528	T R		1030-1220	A-210	HALSETH J
461 HISTORY OF THE AMERICAN FRONTIER - 1 COURSE					
4534	M W		230 - 420	X-112	MARTINSON A
494 SEMINAR IN AMERICAN HISTORY - 1 COURSE					
4536	M		700	X-112	MARTINSON A
502 HISTORIOGRAPHY AND BIBLIOGRAPHY - 1 COURSE					
4538	T		700	X-107	HALSETH J
596 GRADUATE RESEARCH - 1 COURSE					
9595	TO BE ARRANGED INDEPENDENT STUDY CARD REQUIRED FOR THIS COURSE.				
599 THESIS - 1 COURSE					
9595	TO BE ARRANGED INDEPENDENT STUDY CARD REQUIRED FOR THIS COURSE.				

JOURNALISM

SEE COMMUNICATION ARTS

MATHEMATICS

127 FINITE MATHEMATICS - 1 COURSE					
4614	SEC A	MTWRF	1030	O-104	LIEBELT P
4616	SEC B	M R	330 - 520	O-103	COATS G
133 COLLEGE ALGEBRA AND TRIGONOMETRY - 1 COURSE					
4618	SEC A	MTWRF	1130	O-105	COATS G
4624	SEC B	MTWRF	130	O-103	COATS G
144 COMPUTERS AND PROGRAMMING - 1 COURSE					
4626	M R		330 - 520	A-213	LIEBELT P
151 ANALYTIC GEOMETRY AND CALCULUS - 1 COURSE					
4628	SEC A	MTWRF	1230	O-102	BRINK J
4634	SEC B	MTWRF	750	A-115	BRINK J
152 ANALYTIC GEOMETRY AND CALCULUS - 1 COURSE					
4636	SEC A	MTWRF	850	O-104	HERZOG J
4638	SEC B	MTWRF	130	O-104	MEYER N
231 LINEAR ALGEBRA AND CALCULUS - 1 COURSE					
4644	MTWRF		1230	O-104	JOHNSON W
323 MODERN ELEMENTARY MATHEMATICS - 1 COURSE					
4646	SEC A	MTWRF	230	O-104	BATKER K
4648	SEC B	T R	430 - 620	O-102	BATKER K
324 GEOMETRY FOR THE ELEMENTARY SCHOOL TEACHER - 1/2 COURSE					
4704	M W		430 - 620	O-104	BATKER K
332 MULTIDIMENSIONAL CALCULUS - 1 COURSE					
4706	MTWRF		1230	O-105	HERZOG J
341 MATHEMATICAL STATISTICS - 1 COURSE					
4708	MTWRF		750	O-104	JOHNSON W
346 NUMERICAL ANALYSIS - 1 COURSE					
4714	MTWRF		130	O-105	BRINK J
428 NUMBER THEORY FOR SECONDARY SCHOOL TEACHERS - 1 COURSE					
4716	M		430 - 850	A-207	BATKER K
OPEN TO NSF PARTICIPANTS ONLY					
456 MATHEMATICAL ANALYSIS - 1 COURSE					
4718	MTWRF		850	A-219	MEYER N
491 INDEPENDENT STUDY - 1/4 TO 1 COURSE					
9595	TO BE ARRANGED INDEPENDENT STUDY CARD REQUIRED FOR THIS COURSE.				

SYSTEM CODE NUMBER

597 ↓ GRADUATE RESEARCH - 1/4 TO 1 COURSE
 9595 TO BE ARRANGED
 INDEPENDENT STUDY CARD REQUIRED FOR THIS COURSE.

MUSIC

050 STUDENT RECITAL - 0 CREDIT
 4744 W 1230 EASTVOLD CHAPEL SKONES M
 * REGISTRATION AND ATTENDANCE REQUIRED OF ALL MUSIC MAJORS

120 MUSIC SURVEY - 1 COURSE
 4746 MTWRF 1130 E-227 KING V

124 THEORY - 1 COURSE
 4748 SEC A MTWR 850 E-227 MEYER L
 4804 SEC B MTWR 130 E-227 MEYER L

LITERATURE AND PERFORMANCE - 1/4 COURSE

FROSH	SOPH	JUNIOR	SENIOR	
130	230	330	430	CHOIR OF THE WEST SKONES M
	M W F	330 - 450	E-227	
	T R	430 - 550	E-227	
131	231	331	431	UNIVERSITY CHORALE HARMIC
SEC A	M W F	330 - 450	E-228	
	T R	330 - 550	E-228	
SEC B	T	700 - 920	X-201	HARMIC
132	232	332	432	MADRIGAL SINGERS + VOCAL ENSEMBLE
	TO BE ARRANGED			
133	233	333	433	UNIVERSITY BAND GILBERTSON G
	M W F	500	E-228	
	R	700	E-228	
134	234	334	434	UNIVERSITY ORCHESTRA KRACHT J
	M	700	E-228	
	T R	330	E-228	
135	235	335	435	CHAMBER ENSEMBLE TREMAINE MEYER L
SEC A	M W	1130	E-230S	
SEC B	T	700	E-228	
136	236	336	436	TWO PIANO ENSEMBLE KNAPP C
	TO BE ARRANGED			
137	237	337	437	ACCOMPANYING KNAPP C
	TO BE ARRANGED			

REGISTRATION FOR LITERATURE AND PERFORMANCE MUST BE COMPLETED AT THE MUSIC DEPARTMENT OFFICE E-215. THE REGISTRARS OFFICE WILL RECEIVE AN OFFICIAL LIST OF REGISTRANTS FROM THE MUSIC DEPARTMENT AFTER THE TERM HAS BEGUN.

INITIAL CHARGES TO YOUR ACCOUNT IN THE BUSINESS OFFICE WILL NOT INCLUDE THE CHARGES FOR ANY ONE OF THESE COURSES BUT WILL BE ADDED TO YOUR ACCOUNT AFTER ALL REGISTRATIONS ARE FINALIZED BY THE DEPARTMENT.

NOTE---IF YOU ARE REGISTERING FOR LITERATURE AND PERFORMANCE ONLY, IT WILL BE NECESSARY FOR YOU TO COMPLETE ADDITIONAL FORMS AT THE REGISTRARS OFFICE.

PRIVATE LESSONS - 1/4 TO 1 COURSE

FROSH	SOPH	JUNIOR	SENIOR	
150	250	350	450	PIANO
151	251	351	451	ORGAN
152	252	352	452	VOICE
153	253	353	453	VIOLIN-VIOLA
154	254	354	454	CELLO-BASS
155	255	355	455	WOODWINDS
156	256	356	456	BRASS
157	257	357	457	PERCUSSION

STUDENTS REGISTERED FOR PRIVATE LESSONS SHOULD TRY TO KEEP FRIDAY 6TH HOUR OPEN FOR GROUP MEETINGS.

REGISTRATION FOR PRIVATE LESSONS MUST BE COMPLETED AT THE MUSIC DEPARTMENT OFFICE E-215. THE REGISTRARS OFFICE WILL RECEIVE AN OFFICIAL LIST OF REGISTRANTS FROM THE MUSIC DEPARTMENT AFTER THE TERM HAS BEGUN.

INITIAL CHARGES TO YOUR ACCOUNT IN THE BUSINESS OFFICE WILL NOT INCLUDE PRIVATE LESSONS BUT WILL BE ADDED TO YOUR ACCOUNT WHEN THE REGISTRATIONS ARE FINALIZED.

NOTE---IF YOU ARE REGISTERING FOR PRIVATE LESSONS ONLY, IT WILL BE NECESSARY FOR YOU TO COMPLETE YOUR REGISTRATION AT THE REGISTRARS OFFICE.

212 HISTORY OF MUSIC - 1 COURSE
 6272 MTWR 130 E-228 KING V

224 THEORY - 1 COURSE
 6274 MTWR 850 E-228 ROBBINS D

244 WOODWINDS INSTRUMENTAL LABORATORY - 1/4 COURSE
 6280 M F 1230 E-228 KRACHT J

326 ORCHESTRATION - 1/2 COURSE
 6282 W 700 - 850 E-227 MEYER N

SYSTEM CODE NUMBER

339 ↓ BASIC CONDUCTING - 1/2 COURSE
 6284 T R 1230 E-227 KRACHT J

340 MUSIC IN THE ELEMENTARY SCHOOL - 1/2 COURSE
 6290 SEC A M W 1030 E-228 GILBERTSON G
 6292 SEC H M W 230 E-228 GILBERTSON G

341 MUSIC SKILLS AND METHODS FOR ELEMENTARY TEACHERS - 1 COURSE
 6294 MTWRF 230 E-228 GILBERTSON G

368 WORSHIP AND LITURGY - 1 COURSE
 6350 M WRF 1030 E-227 DAHL D

423 ADVANCED FORM AND ANALYSIS - 1 COURSE
 6352 MTWR 1130 E-228 ROBBINS D

442 VOCAL PEDAGOGY - 1/2 COURSE
 6354 T 700 - 850 E-227 SARE W

491 INDEPENDENT STUDY - 1/4 TO 1 COURSE
 9595 TO BE ARRANGED
 INDEPENDENT STUDY CARD REQUIRED FOR THIS COURSE.

590 GRADUATE SEMINAR - 1/4 TO 1 COURSE
 9595 TO BE ARRANGED
 INDEPENDENT STUDY CARD REQUIRED FOR THIS COURSE.

NURSING

254 PATIENT HEALTH TEACHING - 1 COURSE
 SEC A M W 130 - 320 A-212 JACOBSON L
 T F 130 X-112

6374 LAB A M 500- 900 CLINICAL AREA
 T W 700-1230 CLINICAL AREA
 6380 LAB B W 500- 900 CLINICAL AREA
 R F 700-1230 CLINICAL AREA
 FROM 1ST THROUGH 7TH WEEK

SEC B M W 130 - 320 A-212 JACOBSON L
 T F 130 X-112

6382 LAB C M 500- 900 CLINICAL AREA
 T W 700-1230 CLINICAL AREA
 6384 LAB D W 500- 900 CLINICAL AREA
 R F 700-1230 CLINICAL AREA
 FROM 8TH THROUGH 13TH WEEK

255 SURGICAL INTERVENTION - 1 COURSE
 SEC A M 1030-1220 A-210 LEE A
 M 130 A-210
 T 1230- 220 A-210
 R 1230 A-210

6390 LAB A M 500- 900 CLINICAL AREA
 T 700-1130 CLINICAL AREA
 W 700- 230 CLINICAL AREA
 6392 LAB B W 500- 900 CLINICAL AREA
 R 700-1130 CLINICAL AREA
 F 700- 230 CLINICAL AREA
 FROM 1ST THROUGH 7TH WEEK

SEC B M 1030-1220 A-210 LEE A
 M 130 A-210
 T 1230- 220 A-210
 R 1230 A-210

6394 LAB C M 500- 900 CLINICAL AREA
 T 700-1130 CLINICAL AREA
 W 700- 230 CLINICAL AREA
 6450 LAB D W 500- 900 CLINICAL AREA
 R 700-1130 CLINICAL AREA
 F 700- 230 CLINICAL AREA
 FROM 8TH THROUGH 13TH WEEK

256 REHABILITATION NURSING - 1 COURSE
 SEC A M 1030-1220 O-106 GOUTU M
 M 130 O-106
 T 1230- 220 O-106
 R 1230 O-106

6452 LAB A T 700-1130 CLINICAL AREA
 W 700- 230 CLINICAL AREA
 6454 LAB B R 700-1130 CLINICAL AREA
 F 700- 230 CLINICAL AREA
 FROM 1ST THROUGH 7TH WEEK

SEC B M 1030-1220 O-106 GOUTU M
 M 130 O-106
 T 1230- 220 O-106
 R 1230 O-106

6460 LAB C T 700-1130 CLINICAL AREA
 W 700- 230 CLINICAL AREA
 6462 LAB D R 700-1130 CLINICAL AREA
 F 700- 230 CLINICAL AREA
 FROM 8TH THROUGH 13TH WEEK

361 MATERNAL-CHILD NURSING - 1 COURSE
 R 330 - 520 O-105 PETERSON W LAVIK D

6464 LAB A MT 700-1130 CLINICAL AREA
 6470 LAB B MT 730-1200 CLINICAL AREA
 6472 LAB C RF 730-1200 CLINICAL AREA

ALLOW 30-45 MINUTES TRAVEL TIME EACH WAY.

SYSTEM CODE NUMBER

362	MATERNAL-CHILD NURSING - I COURSE			
	F	130 - 320	B-106	ROYCE J MILLER
6474	LAB A	RF 730-1200	CLINICAL AREA	
	MT	1230- 500	CLINICAL AREA	
6480	LAB B	MT 730-1200	CLINICAL AREA	
	MT	1230- 500	CLINICAL AREA	
FOUR WEEKS OUT OF THE SEMESTER EACH STUDENT WILL HAVE CLINICAL PRACTICE 1230-500 P.M. ON MONDAY AND TUESDAY RATHER THAN THE MORNING HOURS SCHEDULED. ALLOW 30-45 MINUTES TRAVEL TIME EACH WAY.				
363	MATERNAL-CHILD NURSING - I COURSE			
6482	W	750 - 220	0-106	PETERSON W ROYCE J LAVIK D MILLER
371	PSYCHIATRIC NURSING I - I COURSE			
6484	T F	130 - 320	X-201	JEWELL J LEMIEUX N
372	PSYCHIATRIC NURSING II - I COURSE			
6490	LAB A	MT 750-1220	CLINICAL AREA	JEWELL J LEMIEUX N
	W	1000- 400	CLINICAL AREA	
6492	LAB B	RF 750-1220	CLINICAL AREA	JEWELL J LEMIEUX N
	W	1000- 400	CLINICAL AREA	
ALLOW 75 MINUTES TRAVEL TIME EACH WAY ON WEDNESDAY AND 30-45 MINUTES ON THE OTHER DAYS.				
411	TRENDS IN NURSING - 1/2 COURSE			
6494	SEC A	T 400 - 620	0-104	STUCKE D
6550	SEC B	R 400 - 620	0-104	STUCKE D
445	FUNDAMENTALS OF COMMUNITY HEALTH - 1/2 COURSE			
6552	R	750 - 940	IVY LOUNGE	BERGERSON L
446	COMMUNITY NURSING - I COURSE			
6554	LAB	MTW F 750 -1200	CLINICAL AREA	BERGERSON LING
450	SELECTED CLINICAL PROBLEMS I - I COURSE			
6560	M	130 - 320	IVY LOUNGE	CONE D LEAKE P HAUGHEE
	ALL SEMESTER			
	W	230	IVY LOUNGE	
	F	750 - 940	IVY LOUNGE	
	LAB	W 750- 220	CLINICAL AREA	
		AND AS ARRANGED		
1ST THROUGH 7TH WEEK ONLY				
451	SELECTED CLINICAL PROBLEMS II - I COURSE			
6562	M F	1030-1220	IVY LOUNGE	CONE D LEAKE P HAUGHEE
	ALL SEMESTER			
	F	130	IVY LOUNGE	
	LAB	T R 750- 220	CLINICAL AREA	
		AND AS ARRANGED		
1ST THROUGH 7TH WEEK ONLY				
452	NURSING LEADERSHIP - I COURSE			
6564	M	750 - 940	IVY LOUNGE	CONE D LEAKE P HAUGHEE
	ALL SEMESTER			
	LAB	TWRF 750- 420	CLINICAL AREA	
		8TH THROUGH 13TH WEEK ONLY		
491	INDEPENDENT STUDY - 1/4 TO I COURSE			
9595	TO BE ARRANGED			
INDEPENDENT STUDY CARD REQUIRED FOR THIS COURSE.				

PHILOSOPHY

201	PRINCIPLES OF PHILOSOPHY - I COURSE			
6590	SEC A	MTWRF 850	A-200	SIMMONDS K
6592	SEC B	MTWRF 1030	A-213	ARBAUGH G
6594	SEC C	MTWRF 1130	A-204	ARBAUGH G
221	ETHICAL THEORY - I COURSE			
7050	MTWRF	1030	0-105	SAIBEL B
233	LOGIC - I COURSE			
7052	MTWRF	1130	A-210	MYRBO G
333	RATIONALISM AND THE ENLIGHTENMENT - I COURSE			
7054	MTWRF	330	A-215	SIMMONDS K
335	CONTEMPORARY PHILOSOPHY - I COURSE			
7060	T	700	A-200	MYRBO G
411	PHILOSOPHY OF RELIGION - I COURSE			
7062	MTWRF	130	A-223	SIMMONDS K

SYSTEM CODE NUMBER

491 ↓ INDEPENDENT READING AND RESEARCH - 1/4 TO 1/2 COURSE
9595 TO BE ARRANGED
INDEPENDENT STUDY CARD REQUIRED FOR THIS COURSE.

PHYSICAL EDUCATION

100	ORIENTATION TO PHYSICAL EDUCATION - 1/4 COURSE			
PE 100 IS REQUIRED FOR GRADUATION AND SHOULD BE TAKEN DURING THE FRESHMAN YEAR. LECTURE AND LAB INSTRUCTORS NEED NOT COINCIDE				
	SEC A	T 850	A-101	HOSETH P
	SEC B	M 1230	X-201	PHILLIPS C
STUDENTS MUST PLAN TO ATTEND ONE LECTURE PER WEEK				
7084	LAB A	R 850	OLSON BALCONY	HOSETH P
7090	LAB B	F 850	O FIELDHOUSE	HOSETH P
7092	LAB C	M 1030	O FIELDHOUSE	PHILLIPS C
7094	LAB D	W 1030	OLSON BALCONY	PHILLIPS C
7150	LAB E	F 1030	OLSON BALCONY	PHILLIPS C
7152	LAB F	F 1130	O FIELDHOUSE	PHILLIPS C
7154	LAB G	W 130	O FIELDHOUSE	PHILLIPS C
7160	LAB H	F 130	O FIELDHOUSE	PHILLIPS C
201	BEGINNING GOLF - 1/4 COURSE			
7174	LAB A	T R 750	O FIELDHOUSE	CARLSON R
7180	LAB B	T R 850	O FIELDHOUSE	CARLSON R
202	INTERMEDIATE AND ADVANCED GOLF - CO-ED - 1/4 COURSE			
7184	LAB A	W F 750	O FIELDHOUSE	LUNDGAARD G
7190	LAB B	T R 1030	O FIELDHOUSE	LUNDGAARD G
203	ARCHERY - 1/4 COURSE			
7194	W F	1230	O FIELDHOUSE	PHILLIPS C
204	BOWLING - 1/4 COURSE			
\$10.00 FEE REQUIRED				
7252	LAB A	M 750 - 940	U CENTER BOWL	THIEMAN
7254	LAB B	W 750 - 940	U CENTER BOWL	THIEMAN
7260	LAB C	F 750 - 940	U CENTER BOWL	THIEMAN
7262	LAB D	M 1130- 120	U CENTER BOWL	LUNDGAARD G
7264	LAB E	W 1130- 120	U CENTER BOWL	LUNDGAARD G
7270	LAB F	T 750 - 940	U CENTER BOWL	MAYS T
7272	LAB G	M 130 - 320	U CENTER BOWL	MAYS T
7274	LAB H	W 130 - 320	U CENTER BOWL	THIEMAN
207	GYMNASTICS - 1/4 COURSE			
7284	M W	130	OLSON BALCONY	HOSETH P
208	SKIING - 1/4 COURSE			
7290	CRYSTAL MOUNTAIN			THIEMAN J
INFORMATION SHEET AVAILABLE IN REGISTRARS OFFICE				
LECTURES - FEB 9, 16, 23, MAR 16 IN A-101 AT 700 PM				
SLOPE LESSONS - FEB 14, 21, 28, MAR 7, 14, 21				
\$30.00 FEE REQUIRED				
209	INTERMEDIATE GYMNASTICS - 1/4 COURSE			
7292	M W	1230	OLSON BALCONY	HOSETH P
210	SLIMNASTICS - WOMEN - 1/4 COURSE			
7294	M W	850	OLSON BALCONY	PHILLIPS C
211	BEGINNING BADMINTON - 1/4 COURSE			
7350	M W	1130	OLSON GYM	MAYS T
212	INTERMEDIATE BADMINTON - 1/4 COURSE			
7352	M W	1230	OLSON GYM	OFFICER S
214	BEGINNING TENNIS - 1/4 COURSE			
7354	LAB A	T R 1030	OLSON GYM	PHILLIPS C
7360	LAB B	T R 130	OLSON GYM	MAYS T
215	INTERMEDIATE TENNIS - 1/4 COURSE			
7362	M W	1030	OLSON GYM	
219	CANOEING - 1/4 COURSE			
7364	R	130 - 320	SPANAWAY LK	PHILLIPS C
\$5.00 FEE REQUIRED. THE FIRST SESSION WILL BE HELD IN THE PLU POOL. ADVANCED SWIMMING STATUS IS REQUIRED.				
222	HANDBALL, SQUASH AND PADDLEBALL - MEN - 1/4 COURSE			
7370	LAB A	T R 850	HANDBALL COURT	LUNDGAARD G
7372	LAB B	M W 1030	HANDBALL COURT	LUNDGAARD G
7374	LAB C	T R 1030	HANDBALL COURT	MAYS T
7380	LAB D	M W 1130	HANDBALL COURT	CARLSON R
7382	LAB E	T R 1130	HANDBALL COURT	MAYS T
223	SQUASH AND PADDLEBALL - WOMEN - 1/4 COURSE			
7384	LAB A	T R 130	HANDBALL COURT	TEMPLIN
7390	LAB B	T R 230	HANDBALL COURT	TEMPLIN
7392	LAB C	W F 850	HANDBALL COURT	OFFICER S
227	WEIGHT TRAINING - MEN - 1/4 COURSE			
7394	T R	1030	WEIGHT ROOM	OLSON D
228	BASIC MOUNTAINEERING - 1/4 COURSE			
7450	LECTURES IN G-102 AT 730 P.M. ON MAR 31, APRIL 14, 21, 28 AND MAY 5. CLIMBS ON APRIL 3, 17, 24, AND MAY 1, 8.			PHILLIPS J

SYSTEM CODE NUMBER

229	↓	EQUITATION - 1/4 COURSE 7452	TO BE ARRANGED		OLSON D
		AT SAINT MARTINS FEE \$50.00 STUDENT MUST ARRANGE OWN TRANSPORTATION			
230		BEGINNING SWIMMING - 1/4 COURSE			
7460		LAB A M W	850	PCCL	CHASE G
7462		LAB B M W	1130	PCCL	CHASE G
231		INTERMEDIATE SWIMMING - 1/4 COURSE			
7464		M W	1030	PCCL	CHASE G
232		ADVANCED SWIMMING - 1/4 COURSE			
7470		M W	130	PCCL	CHASE G
234		SENIOR LIFE SAVING - 1/4 COURSE			
7472		T	700	POOL	CHASE G
235		WATER SAFETY INSTRUCTION - 1/4 COURSE			
7474		T R	850	POOL	CHASE G
237		SKIN AND SCUBA DIVING - 1/4 COURSE			
7480		LAB A T R	1230	PCCL	CHASE G
7482		LAB B T R	130	POOL	CHASE G
240		FOLK AND SOCIAL DANCE - 1/4 COURSE			
7484		T R	1230	MEMORIAL GYM	PHILLIPS C
241		BEGINNING MODERN DANCE - 1/4 COURSE			
7490		M W	130	MEMORIAL GYM	LEROY
242		INTERMEDIATE MODERN DANCE - 1/4 COURSE			
7492		M W	230	MEMORIAL GYM	LEROY
252		BASKETBALL AND SOFTBALL - WOMEN - 1/4 COURSE			
7494		LAB A T R	850	MEMORIAL GYM	OFFICER S
7550		LAB B T R	1030	MEMORIAL GYM	OFFICER S
254		BASKETBALL AND SOFTBALL - MEN - 1/4 COURSE			
7552		LAB A M W	750	OLSON GYM	MAYS T
7554		LAB B M W	850	OLSON GYM	MAYS T
277		SCIENTIFIC FOUNDATIONS OF PHYSICAL EDUCATION - 1 COURSE			
7560		MT RF	1130	0-103	OLSON D
281		INJURY PREVENTION AND THERAPEUTIC CARE - 1/2 COURSE			
7562		F R	1230	0-103	CARLSON R
286		PROFESSIONAL ACTIVITIES, GYMNASTICS AND DANCE - 1 COURSE			
7564		MTWRF	230	OLSON BALCONY	CARLSON R
295		SCHOOL HEALTH - 1/2 COURSE			
7570		LAB A M W	750	0-102	HOSETH P
7572		LAB B M W	850	0-102	HOSETH P
332		OFFICIATING - 1/2 COURSE			
7574		M W F	230	0-103	OFFICER S
360		TEACHING PRACTICUM - 1/2 COURSE			
7580		TO BE ARRANGED			OLSON D
361		COACHING PRACTICUM - 1/2 COURSE			
7582		TO BE ARRANGED			OLSON D
370		COACHING THEORY - BASKETBALL - 1/2 COURSE			
7592		M W	850	0-103	LUNDEGAARD G
374		COACHING THEORY - WRESTLING - 1/2 COURSE			
7594		T R	1030	0-103	CARLSON R
392		CORRECTIVE THERAPY - 1 COURSE			
8050		T R	1230- 420	AMER LK HOSP	SOUZA
482		BIOMECHANICS OF HUMAN MOTION - 1 COURSE			
8052		MTWR	750	0-103	CHASE G
483		RECREATION ADMINISTRATION - 1 COURSE			
8054		M	700	0-102	SWENSON M
491		INDEPENDENT STUDY - 1/2 OR 1 COURSE			
9595		TO BE ARRANGED			OLSON D
		INDEPENDENT STUDY CARD REQUIRED FOR THIS COURSE.			
597		GRADUATE RESEARCH - 1/2 TO 1 COURSE			
9595		TO BE ARRANGED			OLSON D
		INDEPENDENT STUDY CARD REQUIRED FOR THIS COURSE.			

PHYSICS

102		DISCOVERY PHYSICS - 1 COURSE			
		M W F	1030	R-108	JACOBS C
8084		LAB A	h	230 - 520	R-112
8090		LAB B	R	1030- 120	R-112
112		HONORS GENERAL PHYSICS - 1 COURSE			
		M W F	1030	R-112	NCRNES S
8092		LAB A	M	130 - 420	R-120
8094		LAB B	T	130 - 420	R-120
		BY DEPARTMENTAL INVITATION ONLY			

SYSTEM CODE NUMBER

253	↓	GENERAL PHYSICS - 1 COURSE			
		M W F	750	R-112	JACOBS C
8150		LAB A	M	130 - 420	R-112
8152		LAB B	T	130 - 420	R-112
		DIS A	T	750	R-112
		DIS B	R	750	R-112
272		ELECTRICAL CIRCUITS AND INSTRUMENTATION - 1 COURSE			
8154		M W F	850	R-120	NCRNES S
		LAB	h	230 - 520	R-120
		DIS	T R	850	R-120
322		ADVANCED LABORATORY - 1/4 TO 1/2 COURSE			
8160		LAB	T	130 - 520	R-117
334		MECHANICS - 1 COURSE			
8162		MTWRF	1030	L-106	TANG K
406		ADVANCED MODERN PHYSICS - 1 COURSE			
8164		MTWRF	1030	L-103	ADAMS H
422		ADVANCED LABORATORY - 1/4 TO 1/2 COURSE			
8170		LAB	R	130 - 520	R-117
456		MATHEMATICAL PHYSICS - 1 COURSE			
8172		MTWRF	1230	L-106	TANG K
491		INDEPENDENT STUDY - 1/4 TO 1 COURSE			
9595		TO BE ARRANGED			
		INDEPENDENT STUDY CARD REQUIRED FOR THIS COURSE.			
497		RESEARCH - 1/4 TO 1 COURSE			
9595		TO BE ARRANGED			
		INDEPENDENT STUDY CARD REQUIRED FOR THIS COURSE.			

POLITICAL SCIENCE

101		INTRODUCTION TO POLITICAL SCIENCE - 1 COURSE			
8192		SEC A	MTWRF	1130	A-207
8194		SEC B	MTWRF	1230	A-202
251		AMERICAN NATIONAL GOVERNMENT - 1 COURSE			
8250		MTWRF	750	X-112	CULVER L
326		RECENT POLITICAL THOUGHT - 1 COURSE			
8252		MTWRF	850	X-112	FARMER D
336		INTERNATIONAL ORGANIZATION AND LAW - 1 COURSE			
8254		MTWRF	1030	X-112	ULBRICHT P
354		AMERICAN STATE AND LOCAL GOVERNMENT - 1 COURSE			
8260		MTWRF	130	0-102	CULVER L
		PART OF ENVIRONMENTAL STUDIES SEMESTER. SEE CROSS REFERENCED COURSES.			
364		THE LEGISLATIVE PROCESS - 1 COURSE			
8262		M W	430	A-202	FARMER D
401		CURRENTS IN CONTEMPORARY POLITICAL THEORY - 1 COURSE			
8264		T R	430	A-212	
454		AMERICAN CONSTITUTIONAL LAW - 1 COURSE			
8270		MTWRF	230	A-208	ULBRICHT P
458		INTERNSHIP IN PUBLIC ADMINISTRATION - 1 COURSE			
8272		M W	330	X-107	MORK
466		INTERNSHIP-WASHINGTON STATE LEGISLATURE - 2 1/2 COURSES			
8274		M W	330	A-202	FARMER D
481		STATISTICAL METHODS - 1 COURSE			
		SEE CROSS REFERENCED COURSES			
497		INDEPENDENT READING AND RESEARCH - 1/4 TO 1 COURSE			
9595		TO BE ARRANGED			
		INDEPENDENT STUDY CARD REQUIRED FOR THIS COURSE.			
597		GRADUATE RESEARCH - 1/4 TO 1 COURSE			
9595		TO BE ARRANGED			
		INDEPENDENT STUDY CARD REQUIRED FOR THIS COURSE.			

PSYCHOLOGY

101		INTRODUCTION TO PSYCHOLOGY - 1 COURSE			
8350		SEC A	MTWRF	1030	A-206
8352		SEC B	MTWRF	130	A-200
8354		SEC C	MTWRF	330	A-260
110		STUDY SKILLS - 1/2 COURSE			
8360		MTWRF	330	A-212	LARSGAARD J
221		THE PSYCHOLOGY OF ADJUSTMENT - 1/2 COURSE			
8362		T R	130	A-207	ADACHI
		DISCUSSIONS TO BE ARRANGED			

SYSTEM CODE NUMBER

243	SCIENTIFIC METHODS - 1/2 TO 1 COURSE	M	330	A-204	NCLPH J
8364	LAB A	T	1030-1220	X-112	NOLPH J
8370	LAB B	R	1030-1220	X-112	NCLPH J
330	SOCIAL PSYCHOLOGY - 1 COURSE	M WRF	850	A-211	NCLPH J
8372					
335	THE CHILDHOOD AND ADOLESCENCE - 1 COURSE	R	130 - 320	X-201	WEBSTER M
8374	DIS A	W	830	X-203	WEBSTER M
	FOR THOSE DOING FIELD WORK AT THE VALLEY SCHOOL OF SPECIAL EDUCATION				
8380	DIS B	R	330	X-112	WEBSTER M
405	ADOLESCENT PSYCHOLOGY - 1/2 COURSE	W	700	A-206	WEBSTER M
8382					
410	EMOTION AND MOTIVATION - 1/2 TO 1 COURSE	T R	430 - 550	X-112	WEBSTER M
8384					
421	BEHAVIOR DISORDERS - 1 COURSE	M	700	A-204	SEVERTSON S
8390					
481	STATISTICAL METHODS - 1 COURSE	SEE CROSS REFERENCED COURSES			
490	HISTORY AND SYSTEMS IN PSYCHOLOGY - 1 COURSE	T	700	X-112	BEXTON H
8392					
491	INDEPENDENT STUDY - 1/4 TO 1/2 COURSE	TO BE ARRANGED INDEPENDENT STUDY CARD REQUIRED FOR THIS COURSE.			
9595					
492	INDEPENDENT STUDY - 1/4 TO 1/2 COURSE	TO BE ARRANGED INDEPENDENT STUDY CARD REQUIRED FOR THIS COURSE.			
9595					
493	INDEPENDENT STUDY - 1/4 TO 1/2 COURSE	TO BE ARRANGED INDEPENDENT STUDY CARD REQUIRED FOR THIS COURSE.			
9595					
515	PSYCHOLOGICAL ASSESSMENT - 1 COURSE	T R	430 - 550	X-203	SEVERTSON S
8474					
570	PRACTICUM IN COUNSELING AND TESTING - 1 COURSE	TO BE ARRANGED			
8480					SEVERTSON S
577	SUPERVISED FIELD WORK - 1 COURSE	TO BE ARRANGED			
8482					SEVERTSON S
596	INDEPENDENT RESEARCH - 1/4 TO 1 COURSE	TO BE ARRANGED INDEPENDENT STUDY CARD REQUIRED FOR THIS COURSE.			
9595					
597	INDEPENDENT RESEARCH - 1/4 TO 1 COURSE	TO BE ARRANGED INDEPENDENT STUDY CARD REQUIRED FOR THIS COURSE.			
9595					
599	THESIS AND THESIS SEMINAR - 1 COURSE	W	700	X-112	BEXTON H
8592					

RELIGION

103	JUDAEO-CHRISTIAN LIFE AND THOUGHT - 1 COURSE	SEC A	MTWRF	750	A-207	EKLUND E
9072						MATHRE
9074	SEC B	T R	330 - 520	A-207		
203	BIBLICAL LITERATURE - 1 COURSE	SEC A	MTWR	850	A-202	GOVIG S
9080						GOVIG S
9082	SEC B	MTWR	1130	A-202		KNUTSON D
9084	SEC C	TWRF	130	A-101		
331	WORLD RELIGIONS - 1 COURSE	SEC A	T	700 - 920	A-204	GOVIG S
9090						KNUTSON D
9092	SEC B	MT RF	1130	A-115		
339	MAN - RELIGIOUS AND HUMAN - 1 COURSE	T R	230 - 420	A-223		PETERSEN J
9094						
341	AMERICAN CHURCHES - 1 COURSE	T R	430 - 550	A-200		EKLUND E
9150						
430	CHRISTIAN THOUGHT AND THE MODERN CONSCIOUSNESS - 1 COURSE	M W	430 - 550	A-210		KNUTSON D
9152						
	PART OF ENVIRONMENTAL STUDIES SEMESTER. SEE CROSS REFERENCED COURSES.					
490	SENIOR SEMINAR - HUMAN SEXUALITY - 1 COURSE	M W	230 - 420	A-223		EKLUND E
9154						OLSON L
491	INDEPENDENT STUDY - 1/2 COURSE	TO BE ARRANGED INDEPENDENT STUDY CARD REQUIRED FOR THIS COURSE.				
9595						

SOCIOLOGY

101	SOCIAL ISSUES - 1 COURSE	SEC A	MTWRF	750	A-204	NELSON N
9184						JOBST R
9190	SEC B	MTWRF	1030	A-202		

SYSTEM CODE NUMBER

9192	SEC C	MTWRF	1130	A-206	HANSON V	
9194	SEC D	MTWRF	130	A-204	GRIGGS	
251	CULTURAL ANTHROPOLOGY - 1 COURSE	M W	430 - 550	A-206	WALTER G	
9254						
325	MINORITIES - 1 COURSE	T R	330 - 450	A-211	MENZEL	
9260						
338	DEVIANT BEHAVIOR - 1 COURSE	SEC A	MTWRF	1130	O-102	OBERHOLTZER D
9262						OBERHOLTZER D
9264	SEC B	MTWRF	130	A-213		
365	SOCIAL INTERVENTION - 1 COURSE	T	700	A-213	HANSON V	
9270						
382	ETHNOLOGY OF AFRICA - 1 COURSE	MTWRF	1030	A-101	WALTER G	
9272						
408	SOCIAL WORK PRACTICE - 1 COURSE	T R	100 - 420	X-107	GILBERTSON W	
9274						
	CONSENT OF INSTRUCTOR REQUIRED					
410	INTERVIEWING - 1/2 COURSE	W	700	X-107	GILBERTSON G	
9280						
	CONSENT OF INSTRUCTOR REQUIRED					
421	FIELD EXPERIENCE - 1 COURSE	M	230	X-107	GILBERTSON G	
9282						
	CONSENT OF INSTRUCTOR REQUIRED					
430	THE COMMUNITY - 1 COURSE	MTWRF	230	A-202	JOBST R	
9284						
445	THE FAMILY - 1 COURSE	MTWRF	330	A-117	SCHILLER J	
9290						
450	SOCIAL INSTITUTIONS - 1 COURSE	M	700	A-206	NELSON N	
9292						
481	STATISTICAL METHODS - 1 COURSE	SEE CROSS REFERENCED COURSES				
490	SEMINAR-RESEARCH - 1 COURSE	SEC A	W	700	A-207	SCHILLER J
9294						
	RESEARCH METHODS					
9350	SEC B	R	700	A-206		
	CORRECTIONS					
491	INDEPENDENT STUDY - 1 COURSE	TO BE ARRANGED INDEPENDENT STUDY CARD REQUIRED FOR THIS COURSE.				
9595						
495	READINGS SEMINAR - 1/2 COURSE	W	1230	X-112	SCHILLER J	
9352						
	SENIOR SOCIOLOGY MAJORS ONLY					
595	GRADUATE READINGS - 1 COURSE	TO BE ARRANGED INDEPENDENT STUDY CARD REQUIRED FOR THIS COURSE.				
9595						
597	GRADUATE RESEARCH - 1 COURSE	TO BE ARRANGED INDEPENDENT STUDY CARD REQUIRED FOR THIS COURSE.				
9595						

CROSS REFERENCED COURSES

481	STATISTICAL METHODS - 1 COURSE	SEC A	MTWRF	1030	A-215	JENSEN R
9394						BEXTON H
9450	SEC B	W	430 - 550	A-217		JENSEN R
9452	SEC C	T R	630 - 820	A-213		

STUDENTS REGISTERING FOR SECTION B ARE EXPECTED TO ATTEND A LAB SESSION ON MONDAY OR TUESDAY AT 430 P.M.
LAB A M 430 - 550 A-217 BEXTON H
LAB B T 430 - 550 A-217 BEXTON H

THE ENVIRONMENTAL STUDIES SEMESTER

IN RECOGNITION OF THE WIDESPREAD STUDENT CONCERN OVER THE GROWING ECOLOGICAL CRISIS, AN ENVIRONMENTAL SEMESTER, WHICH ENABLES THE INTERESTED STUDENT TO STUDY IN DEPTH THE MANY FACETS OF THIS CRISIS FROM THE PERSPECTIVE OF A NUMBER OF DIFFERENT DISCIPLINES, WILL BE OFFERED DURING THE SPRING SEMESTER. STUDENTS ENROLLING IN THE PROGRAM WILL TAKE THE SAME BLOC OF FOUR COURSES AND INTERDISCIPLINARY SEMINAR. THE BLOC OF COURSES CONSISTS OF BIOLOGY 111,222, EARTH SCIENCES 490, POLITICAL SCIENCE 354 AND RELIGION 430. FOUR COURSE CREDITS WILL BE GRANTED TO PARTICIPANTS, AND IT IS UNDERSTOOD THAT, WITH THE EXCEPTION OF A PHYSICAL EDUCATION OR MUSIC COURSE, THIS WILL COMPLETE THE STUDENT'S COURSE LOAD.

THE PROGRAM WILL BE LIMITED TO 25 STUDENTS WITH PREFERENCE GIVEN TO JUNIORS AND SENIORS. IF A STUDENT HAS ALREADY TAKEN ONE OF THE COURSES IN THE BLOC, AN ALTERNATE COURSE MAY BE SUBSTITUTED, HOWEVER, IT IS EXPECTED THAT WITH THIS ONE EXCEPTION, THE STUDENT WILL REGISTER FOR ALL FOUR COURSES. THIS IS REQUIRED FOR ADMISSION INTO THE SEMINAR.

STUDENTS WILL MEET WITH INDIVIDUAL INSTRUCTORS FOR THE FOUR COURSES COMPRISING THE PROGRAM AND THEN ONCE A WEEK IN A SEMINAR-TYPE SITUATION WITH THE FOUR INSTRUCTORS. FIELD TRIPS WILL BE SCHEDULED THROUGHOUT THE SEMESTER, AND SINCE ALL STUDENTS WILL BE TAKING THE SAME BLOC OF COURSES, SCHEDULING PROBLEMS SHOULD NOT ARISE. STUDENTS OTHER THAN THOSE IN ESS MAY ENROLL IN ANY OF THE SEPARATE COURSES, BUT NOT IN THE SEMINAR.

